

Code: 12V/5A/5.5

## POWER SUPPLY ADAPTER 12V/5A/5.5

Net: 10.00 USD Gross: 12.30 USD

Attention! If the power adaptor is using for continuous work (24H) the rated current of the adaptor should be less than 80% of the maximal current.

Please pay attention for proper cooling conditions of the power adaptor during work!



### SPECIFICATION

Adapter type:	Switching
Power voltage:	230 V AC
Voltage frequency range:	47 ... 63 Hz
Output voltage:	12 V DC
Output voltage adjustment:	—
Maximal load:	5 A
Output power:	60 W
Power consumption at no-load:	≤ 0.3 W
Average active efficiency:	86.6 %
Number of outputs:	1 pcs
Power connectors type:	<ul style="list-style-type: none"><li>• 230 V CEE 7/16</li><li>• 12 V - 2.1/5.5 mm Straight plug</li></ul>
Housing type:	Desktop
Protections:	Overload
Weight:	0.31 kg
Dimensions:	121 x 57 x 36 mm
Guarantee:	2 years

### PRESENTATION

DELTA-OPTI Monika Matysiak / VAT:PL5251295225 / 60-713 Poznań, ul. Graniczna 10  
Tel:+48 61 864 69 60 / GSM:+48 607 60 11 66 / Fax:+48 61 864 69 65 / e-mail:shop@delta.poznan.pl  
Monday-Friday: 8.00-19.00 / Saturday: 8.00-14.00

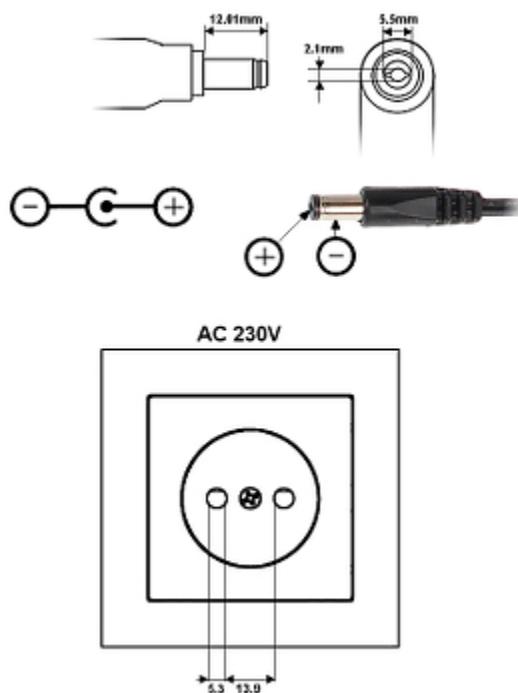

#### PACKAGE

Dimensions (L x W x H): 155x115x45 mm	Gross Weight: 0.34 kg
---------------------------------------	-----------------------

